

230 PARK AVENUE • 10,000 SF RESTAURANT



LEASING BY

Jordan Berger
jberger@mondayre.com
212 692 4393

Co-Broker
Cushman & Wakefield

David A. Green
david.a.green@cushwake.com
212 841 7989

Steven A. Soutendijk
steven.soutendijk@cushwake.com
212 713 6845

230 PARK AVENUE • 10,000 SF RESTAURANT



LEASING BY

Jordan Berger
jberger@mondayre.com
212 692 4393

Co-Broker
Cushman & Wakefield

David A. Green
david.a.green@cushwake.com
212 841 7989

Steven A. Soutendijk
steven.soutendijk@cushwake.com
212 713 6845

230 PARK AVENUE • 10,000 SF RESTAURANT



LEASING BY

Jordan Berger
jberger@mondayre.com
212 692 4393

Co-Broker
Cushman & Wakefield

David A. Green
david.a.green@cushwake.com
212 841 7989

Steven A. Soutendijk
steven.soutendijk@cushwake.com
212 713 6845

230 PARK AVENUE • RESTAURANT



HVAC

24/7 year round cooling via building condenser water.

ELECTRICITY

260 Kilowatts - 800 Amps.
208 to 120 Volts

DOMESTIC WATER, STEAM, GAS AND WASTE LINES

Domestic Water Pressure - 40 to 45lbs.
City Water - 5" brass line.
Steam - 6" line with 7lbs of pressure
Gas - 4" diameter line with low pressure gas (3lbs.)
Waste - 5" diameter line.

VENTING

A path will be provided by the building to the Park Avenue viaduct. A precipitator will be required.

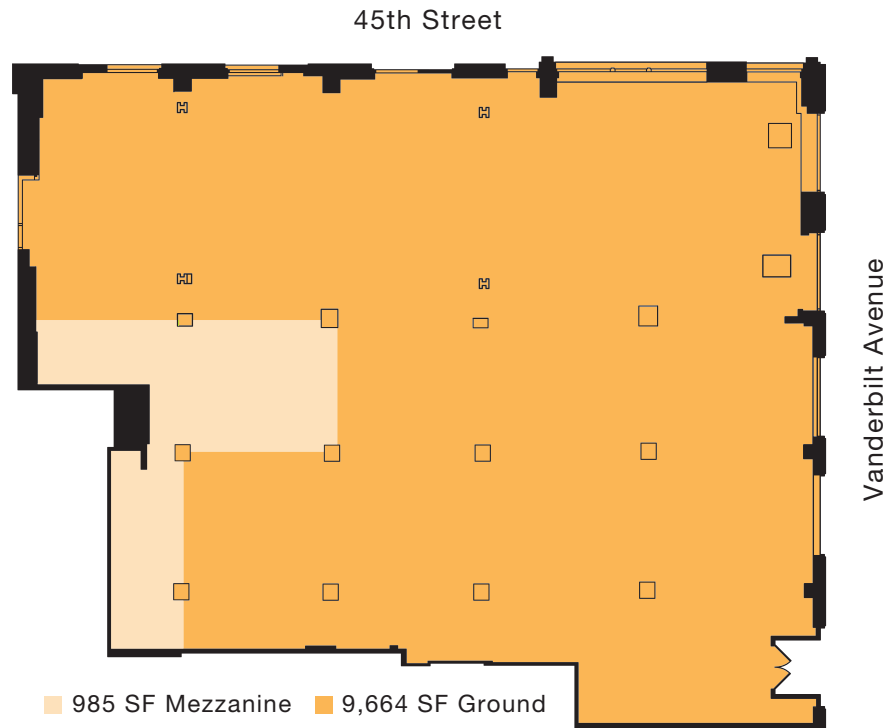

GROUND FLOOR 10,649 SF RESTAURANT



LEASING BY

Jordan Berger
jberger@mondayre.com
212 692 4393

Co-Broker
Cushman & Wakefield

David A. Green
david.a.green@cushwake.com
212 841 7989

Steven A. Soutendijk
steven.soutendijk@cushwake.com
212 713 6845